

LBV 04 - KP.58+548

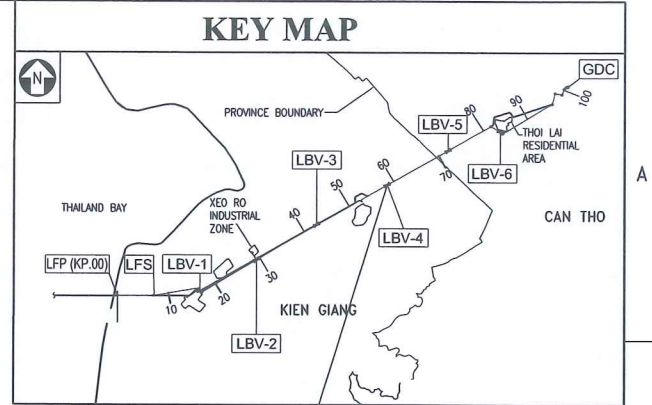
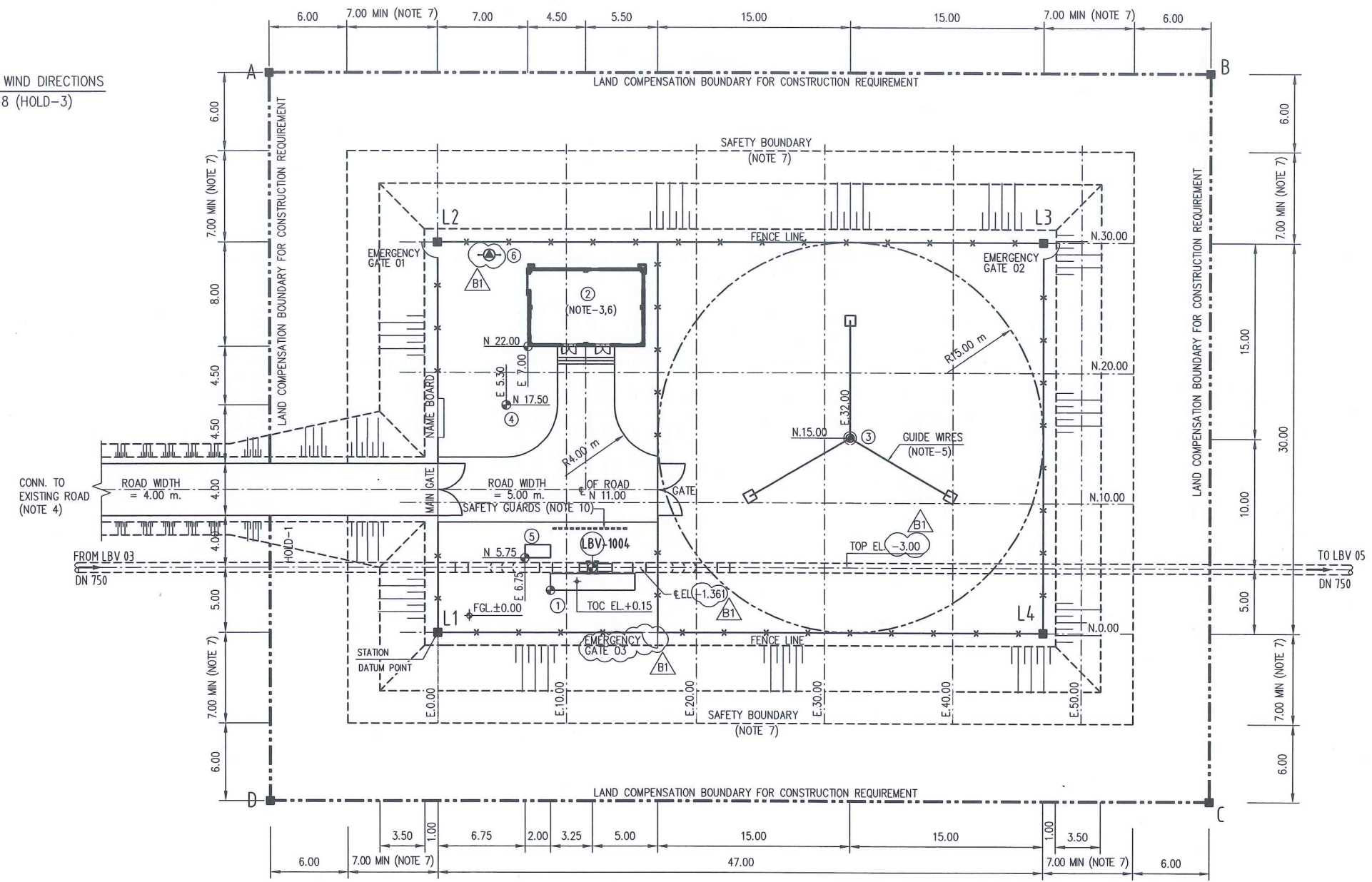
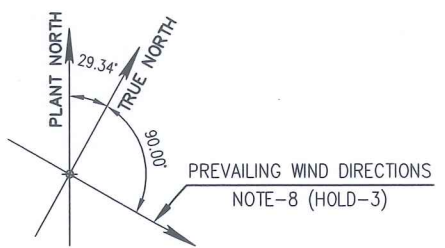

LEGEND

PIPE ABOVE GROUND  
PIPE UNDER GROUND

STATION DATUM COORDINATES  
N 0.00  
E 0.00

VN2000 COORDINATES  
X= 1101151.090  
Y= 593322.300

7	SWG-WPPVE-FEED-60-CI-DAL-0003	-	-
6	SWG-WPPVE-FEED-60-CI-DAL-0002	-	-
5	SWG-WPPVE-FEED-60-CI-DPP-0001	-	-
4	SWG-WPPVE-FEED-70-PL-DCR-0001	-	-
3	SWG-WPPVE-FEED-60-ME-LST-0001	-	-
2	SWG-WPPVE-FEED-00-PR-PFD-0001	B1	-
1	SWG-WPPVE-FEED-60-PR-PID-0004	B1	-

REFERENCE DOCUMENTS/ DRAWINGS			
DATE	DATE	DATE	
WP-PVE	SWPOC	CA	

B1	18/7/17	ISSUED FOR APPROVAL	DNC	TNM/NTS	V.K
A1	22/6/17	ISSUED FOR REVIEW	DNC	TNM/NTS	V.K
REV.	DATE	DESCRIPTION	PRE'D	CHK'D	APP'D

CLIENT:  
PETROVIETNAM OIL AND GAS GROUP  
SOUTHWEST PIPELINE OPERATING COMPANY

CONTRACTOR:  
**WorleyParsons**  
resources & energy  
CONSORTIUM OF WORLEYPARSONS & PV ENGINEERING

PROJECT:  
**BLOCK B - O MON GAS PIPELINE**

STAGE:  
FEED AND COST ESTIMATION UPDATE

TITLE:  
LBV STATION 04 PLOT PLAN

PROJ. CODE	DWG No.	SHEET	REV.
SWG	SWG-WPPVE-FEED-60-PI-DPP-0004	1/1	B1

- NOTES:
- ALL DIMENSIONS ARE IN METERS UNLESS NOTED OTHERWISE.
  - FG. ±0.00 : FINISHED GROUND LEVEL CORRESPONDS TO +2.05 METRE ABOVE NATIONAL ALTITUDES SYSTEM HONDAU - HAI PHONG COORDINATE SYSTEM: VN2000, CENTRAL MERIDIAN: 104°30', ZONE: 3'
  - SOLAR SYSTEM WILL BE INSTALLED ON UTILITY AND GUARD HOUSE
  - ACCESS ROAD REFER TO DWG. No. SWG-WPPVE-FEED-60-CI-DAL-0003
  - GUIDE WIRES ARE INDICATED ONLY, TO BE DESIGNED BY CIVIL
  - UTILITY AND GUARD HOUSE IS TO BE DEVELOPED AND DETAILED BY CIVIL
  - SAFETY BOUNDARY DEFINED ACCORDING TO THE VIETNAM GOVERNMENT DECREE No. 13/2011/NĐ-CP TABLE 9. (SAFETY BOUNDARY SHALL HAVE VISIBLE SIGNS INSTALLED.)
  - WIND DIRECTION BASED ON UCVN-2009/BX0
  - COORDINATES ARE BASED ON PIPELINE ROUTES, DWG NO: SWG-WPPVE-FD-70-PL-DCR-0001
  - TO BE PROVIDED BY CIVIL
- HOLDS:
- COORDINATES TO BE CONFIRMED BY ONSHORE PIPELINE
  - DIMENSIONS
  - PREVAILING WIND

POINT	NATIONAL (VN 2000)		LOCAL		NOTE
	X(m)	Y(m)	EASTING	NORTHING	
L1	1101151.090	593322.300	0.00	0.00	BENCHMARK OF LAND COMPENSATION FENCE BOUNDARY (NOTE 5)
L2	1101177.242	593307.601	0.00	30.000	
L3	1101200.271	593348.573	47.000	30.000	
L4	1101174.119	593363.272	47.000	0.00	
A	1101182.205	593289.899	-13.000	43.000	BENCHMARK OF LAND COMPENSATION FENCE BOUNDARY (NOTE 5)
B	1101217.973	593353.535	60.000	43.000	
C	1101169.156	593380.974	60.000	-13.000	
D	1101133.388	593317.337	-13.000	-13.000	

ITEM No.	DESCRIPTION	SIZE. (m)	EASTING	NORTHING
1	BLOCK VALVE AREA	HOLD-2	8.750	3.250
2	UTILITY AND GUARD HOUSE	HOLD-2	7.000	22.000
3	COLD VENT	HOLD-2	32.000	15.000
4	WINDSOCK	HOLD-2	6.300	17.500
5	PORTABLE NITROGEN SKID	HOLD-2	6.750	5.750
6	POLE MOUNTED TRANSFORMER	HOLD-2	4.000	29.000



THIS DRAWING IS ISSUED BY PV ENGINEERING J.S.C (PVE), THE INFORMATION CONTAINED IN THIS DRAWING IS THE PROPERTY OF WP-PVE AND SWPOC. IT CANNOT BE PUBLISHED, COPIED OR USED FOR ANY PURPOSE WITHOUT APPROVAL FROM WP-PVE/ SWPOC.

PV ENGINEERING J.S.C

LBV 05 - KP.71+978

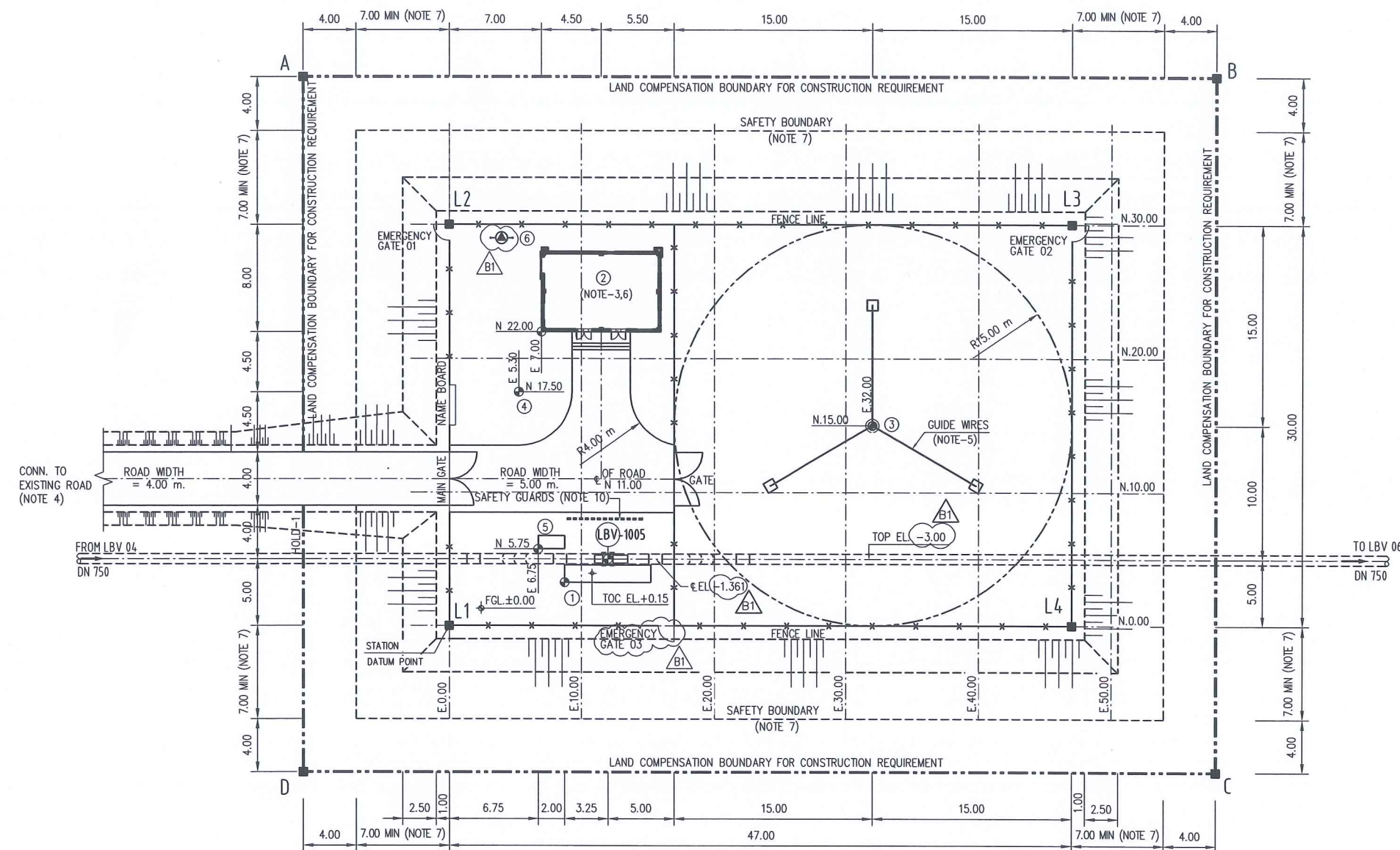
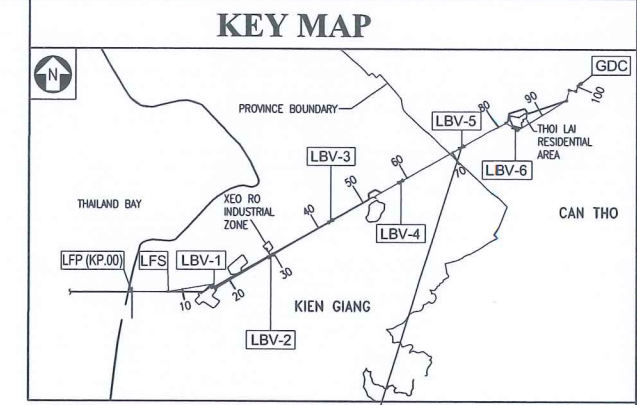

LEGEND

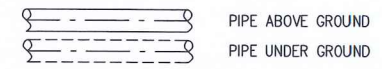

STATION DATUM COORDINATES	VN2000 COORDINATES
N 0.00	X= 1107731.253
E 0.00	Y= 605029.338

NO.	DOCUMENT/ DRAWING NUMBER	REV.	SHT.No.
7	SWG-WPPVE-FEED-60-CI-DAL-0003	-	-
6	SWG-WPPVE-FEED-60-CI-DAL-0002	-	-
5	SWG-WPPVE-FEED-60-CI-DPP-0001	-	-
4	SWG-WPPVE-FEED-70-PL-DCR-0001	-	-
3	SWG-WPPVE-FEED-60-ME-LST-0001	-	-
2	SWG-WPPVE-FEED-00-PR-PFD-0001	B1	-
1	SWG-WPPVE-FEED-60-PR-PID-0005	B1	-

REFERENCE DOCUMENTS/ DRAWINGS			
DATE	DATE	DATE	
WP-PVE	SWPOC	CA	

CLIENT: PETROVIETNAM OIL AND GAS GROUP SOUTHWEST PIPELINE OPERATING COMPANY			
CONTRACTOR: <b>WorleyParsons</b> resources & energy CONSORTIUM OF WORLEYPARSONS & PV ENGINEERING			
PROJECT: BLOCK B - O MON GAS PIPELINE			
STAGE: FEED AND COST ESTIMATION UPDATE			
TITLE: LBV STATION 05 PLOT PLAN			
PROJ. CODE	DWG No.	SHEET	REV.
SWG	SWG-WPPVE-FEED-60-PI-DPP-0005	1/1	B1

- NOTES:
- ALL DIMENSIONS ARE IN METERS UNLESS NOTED OTHERWISE
  - FGL ±0.00 : FINISHED GROUND LEVEL CORRESPONDS TO +2.05 METRE ABOVE NATIONAL ALTITUDES SYSTEM HONDAU - HAI PHONG COORDINATE SYSTEM: VN2000, CENTRAL MERIDIAN: 104°30', ZONE: 3'
  - SOLAR SYSTEM WILL BE INSTALLED ON UTILITY AND GUARD HOUSE
  - ACCESS ROAD REFER TO DWG. No. SWG-WPPVE-FEED-60-CI-DAL-0003
  - GUIDE WIRES ARE INDICATED ONLY, TO BE DESIGNED BY CIVIL
  - UTILITY AND GUARD HOUSE IS TO BE DEVELOPED AND DETAILED BY CIVIL
  - SAFETY BOUNDARY DEFINED ACCORDING TO THE VIETNAM GOVERNMENT DECREE No. 13/2011/NĐ-CP TABLE 9. (SAFETY BOUNDARY SHALL HAVE VISIBLE SIGNS INSTALLED.)
  - WIND DIRECTION BASED ON CCVN: 2009/78X
  - COORDINATES ARE BASED ON PIPELINE ROUTES, DWG NO: SWG-WPPVE-FD-70-PL-DCR-0001
  - TO BE PROVIDED BY CIVIL
- HOLDS:
- COORDINATES TO BE CONFIRMED BY ONSHORE PIPELINE
  - DIMENSIONS
  - PREVAILING WIND

POINT	COORDINATES OF CONTROL POINT LBV 05				NOTE
	NATIONAL (VN 2000)		LOCAL		
	X(m)	Y(m)	EASTING	NORTHING	
L1	1107731.253	605029.338	0.00	0.00	BENCHMARK OF BENCHMARK OF LAND COMPENSATION FENCE BOUNDARY (NOTE 9)
L2	1107757.405	605014.639	0.00	30.000	
L3	1107780.434	605055.610	47.000	30.000	
L4	1107754.282	605070.310	47.000	0.00	
A	1107761.604	604999.660	-11.000	41.000	BENCHMARK OF BENCHMARK OF LAND COMPENSATION FENCE BOUNDARY (NOTE 9)
B	1107795.413	605059.810	58.000	41.000	
C	107750.082	605085.289	58.000	-11.000	
D	1107716.274	605025.139	-11.000	-11.000	

ITEM LIST				
ITEM No.	DESCRIPTION	SIZE. (m)	EASTING	NORTHING
1	BLOCK VALVE AREA	HOLD-2	8.750	3.250
2	UTILITY AND GUARD HOUSE	HOLD-2	7.000	22.000
3	COLD VENT	HOLD-2	32.000	15.000
4	WINDSOCK	HOLD-2	6.30	17.50
5	PORTABLE NITROGEN SKID	HOLD-2	6.750	5.750
6	POLE MOUNTED TRANSFORMER	HOLD-2	4.000	29.000



THIS DRAWING IS ISSUED BY PV ENGINEERING J.S.C. THE INFORMATION CONTAINED IN THIS DRAWING IS THE PROPERTY OF WP-PVE AND SWPOC. IT CANNOT BE PUBLISHED, COPIED OR USED FOR ANY PURPOSE WITHOUT APPROVAL FROM WP-PVE/ SWPOC.

PV ENGINEERING J.S.C

LBV 06 - KP.83+752

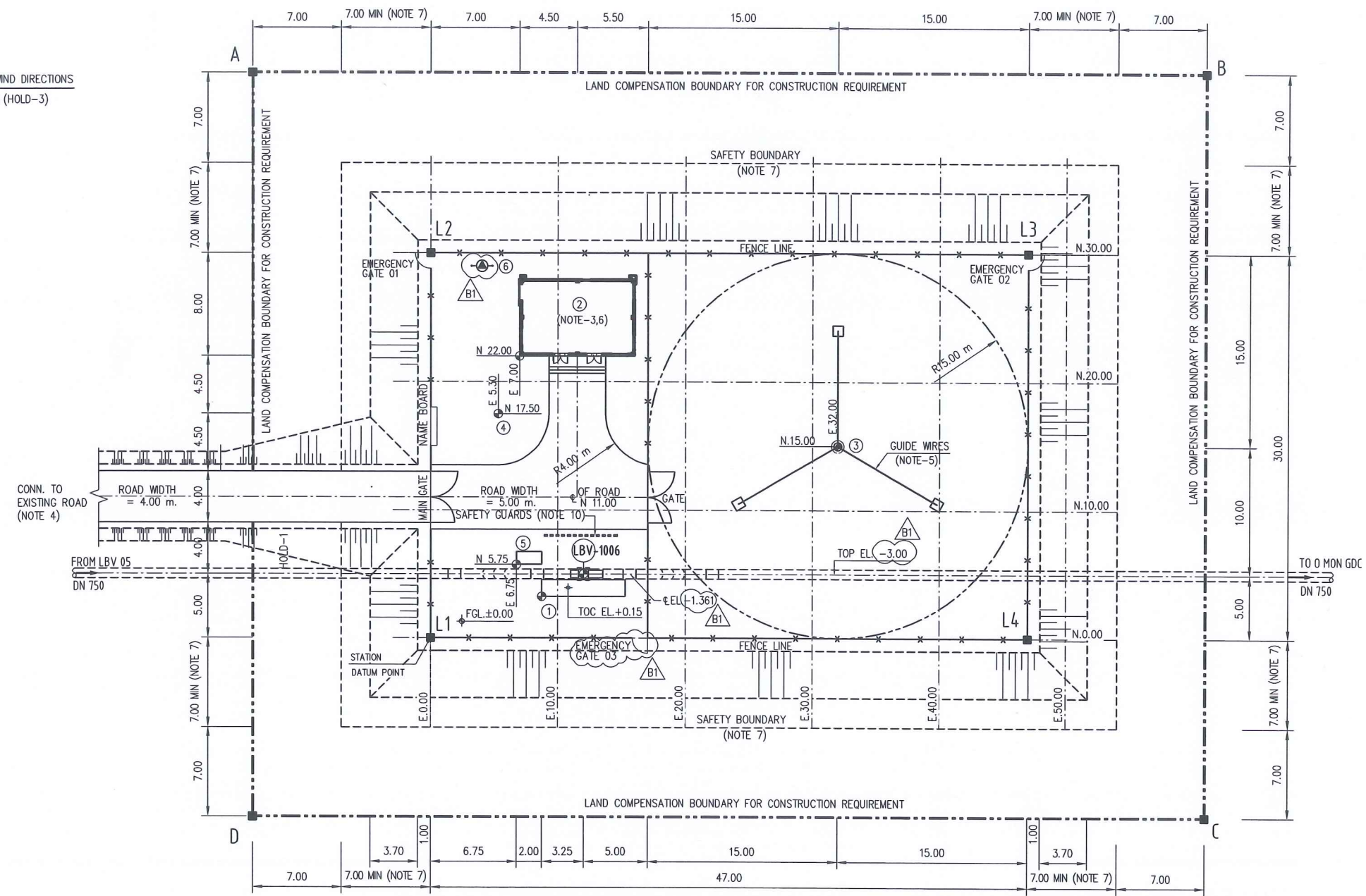
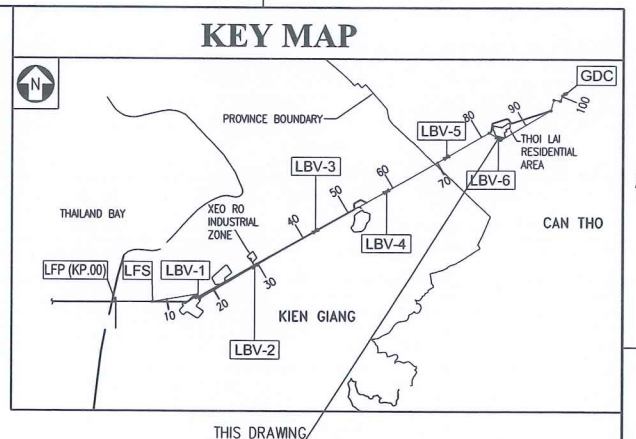
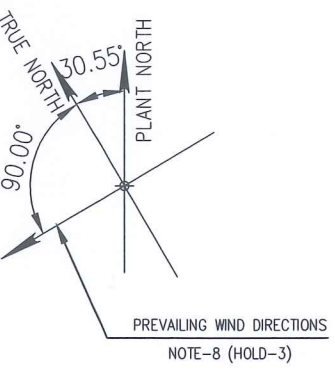

LEGEND



STATION DATUM COORDINATES	VN2000 COORDINATES
N 0.00	X= 1086710.106
E 0.00	Y= 567931.751

NO.	DOCUMENT/ DRAWING NUMBER	REV.	SHT.No.
7	SWG-WPPVE-FEED-60-CI-DAL-0003	-	-
6	SWG-WPPVE-FEED-60-CI-DAL-0002	-	-
5	SWG-WPPVE-FEED-60-CI-DPP-0001	-	-
4	SWG-WPPVE-FEED-70-PL-DCR-0001	-	-
3	SWG-WPPVE-FEED-60-ME-LST-0001	-	-
2	SWG-WPPVE-FEED-00-PR-PFD-0001	B1	-
1	SWG-WPPVE-FEED-60-PR-PID-0006	B1	-

REFERENCE DOCUMENTS/ DRAWINGS				
DATE	DATE	DATE	DATE	DATE
WP-PVE	SWPOC	CA		

- NOTES:**
- ALL DIMENSIONS ARE IN METERS UNLESS NOTED OTHERWISE
  - FGL ±0.00 : FINISHED GROUND LEVEL CORRESPONDS TO (+2.75) METRE ABOVE NATIONAL ALTITUDES
  - SOLAR SYSTEM WILL BE INSTALLED ON UTILITY AND GUARD HOUSE
  - ACCESS ROAD REFER TO DWG. No. SWG-WPPVE-FEED-60-CI-DAL-0003
  - GUIDE WIRES ARE INDICATED ONLY, TO BE DESIGNED BY CIVIL
  - UTILITY AND GUARD HOUSE IS TO BE DEVELOPED AND DETAILED BY CIVIL
  - SAFETY BOUNDARY DEFINED ACCORDING TO THE VIETNAM GOVERNMENT DECREE No. 13/2011/NĐ-CPTABLE 9. (SAFETY BOUNDARY SHALL HAVE VISIBLE SIGNS INSTALLED)
  - WIND DIRECTION BASED ON QCVN:2009/BXD
  - COORDINATES ARE BASED ON PIPELINE ROUTES, DWG NO: SWG-WPPVE-FD-70-PL-DCR-0001
  - TO BE PROVIDED BY CIVIL
- HOLDS:**
- COORDINATES TO BE CONFIRMED BY ONSHORE PIPELINE
  - DIMENSIONS
  - PREVAILING WIND

POINT	NATIONAL (VN 2000)		LOCAL		NOTE
	X(m)	Y(m)	EASTING	NORTHING	
L1	1111464.300	615266.249	0.00	0.00	BENCHMARK OF FENCE BOUNDARY
L2	1111490.136	615281.498	0.00	30.000	
L3	1111466.247	615321.974	47.000	30.000	
L4	1111440.411	615306.725	47.000	0.00	
A	1111509.308	615276.557	-14.000	44.000	BENCHMARK OF LAND COMPENSATION BOUNDARY (NOTE 9)
B	1111471.188	615341.146	61.000	44.000	
C	1111421.238	615311.666	61.000	-14.000	
D	1111459.359	615247.077	-14.000	-14.000	

ITEM No.	DESCRIPTION	SIZE (m)	EASTING	NORTHING
1	BLOCK VALVE AREA	HOLD-2	8.750	3.250
2	UTILITY AND GUARD HOUSE	HOLD-2	7.000	22.000
3	COLD VENT	HOLD-2	32.000	15.000
4	WINDSOCK	HOLD-2	5.30	17.50
5	PORTABLE NITROGEN SKID	HOLD-2	6.750	5.750
6	POLE MOUNTED TRANSFORMER	HOLD-2	4.000	29.000



THIS DRAWING IS ISSUED BY PV ENGINEERING U.S.C (PVE). THE INFORMATION CONTAINED IN THIS DRAWING IS THE PROPERTY OF WP-PVE AND SWPOC. IT CANNOT BE PUBLISHED, COPIED OR USED FOR ANY PURPOSE WITHOUT APPROVAL FROM WP-PVE/ SWPOC.

PV ENGINEERING U.S.C